

ADDITIONAL PRODUCTS

We carry a variety of fence and fencing supplies to meet the needs of every cattleman, whether you have 30 head or 300,000 head of cattle.

- Fence Clips
- Cable and Cable Clips
- Post Caps
- Neckrail Brackets
- Pen Signs, Numbers, and Letters
- Steel Sales
- Steel Posts
- Wood Rails and Wood Posts
- Rail Pins
- Johnson's® Water Tanks and Parts
- Pride of the Farm® Water Tanks and Parts
- Pride of the Farm® Mineral Feeders

SEE MORE ONLINE!

www.mjelivestockequipment.com



ELITE PORTABLE & STATIONARY LOADOUT CHUTES

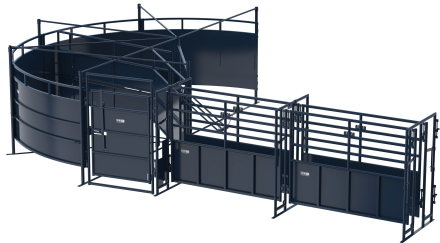

ELITE TUB & ALLEY MODULAR CATTLE SYSTEM



SCAN ME

MJE LE
800 W. CORTEZ ST.
MONTEZUMA, KS 67867
(620)846-6767

WWW.MJELIVESTOCKEQUIPMENT.COM



LIVESTOCK EQUIPMENT

UNIQUELY DESIGNED.
UNIQUELY MADE.

FEEDLOT DOUBLE ALLEY

Heavy-duty, built to last for years in commercial settings.

- Built with ratchet jacks for manual adjustments
- Optional phasing cylinders for hydraulic adjustments
- Constructed with 11 ga., 3/16" and 1/4" square tubing and standard wall pipe
- 11 ga. sheet iron throughout

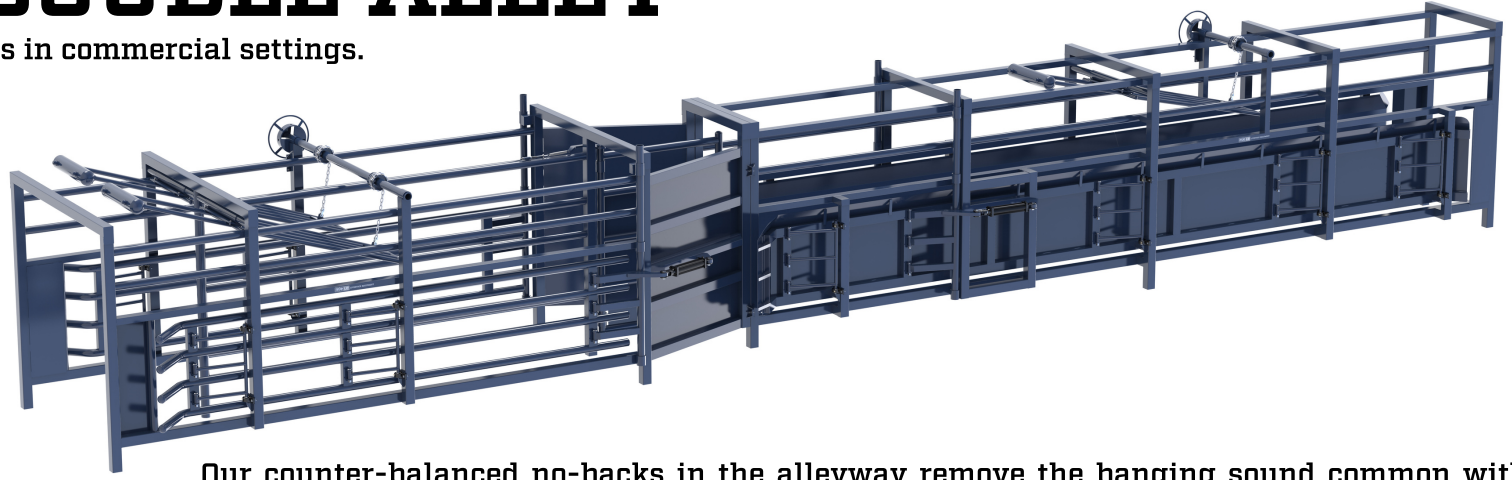

Dimensions

- Full Length - 42'8" / 36'8" / 30'8"
- Width - 7'6"
- Height - 6'6"
- 18'2" Double Alley Section
- 24'6" / 18'6" / 12'6" Single Alley Section Options

Our counter-balanced no-backs in the alleyway remove the banging sound common with older style no-backs. Our heavy-built design outlasts other double alleys and is safer for livestock and handlers.



HEAVY-DUTY FEEDLOT GATES

MJE Livestock Equipment feedlot gates are second-to-none in the industry. Our gates are completely customizable - choose from 3 different weights/strengths, length, number of rails/bars, and select the gate latch options right for your operation.

- Gate hinges have a 3/4" x 3" weld-on hinge block
- Constructed of American-made steel with standard wall pipe on the hinge end
- Top corners are mitered, and all other welds are saddled for maximum strength
- All gates come standard with a chain latch and 3' of chain

Horizontal Bar Options

- 4-Bar (36-1/2" or 42") Special order only
- 5-Bar (42" and 48") In-Stock on standard lengths
- 6-Bar (52", 56-1/2" and 59-1/2") Special order only

Standard Lengths

- 3 ft.
- 4 ft.
- 6 ft.
- 8 ft.
- 10 ft.
- 12 ft.
- 14 ft.
- 16 ft.
- 18 ft.
- 20 ft.

Gate Latch Options

- 7/8" Latch Rod (1" Tube)
- 1" Bent Latch Rod (1-1/4" Tube)
- 1" Straight Latch Rod (1-1/4" Tube)
- Spring Plunger Latch
- Cowboy Spring Plunger Latch
- Double Plunger Latch

Strength Options

- #1 Feedlot Gates (image shown) are made from 1.9" 14 ga. round tubing
- #2 Feedlot Gates are made from 2-3/8" 14 ga. round tubing
- #3 Feedlot Gates are made from 2" schedule 40 pipe (2-3/8" OD)