

NEW! INTRODUCING

The Elite Eliminator Tub & Alley System

FALL 2021



LIVESTOCK EQUIPMENT

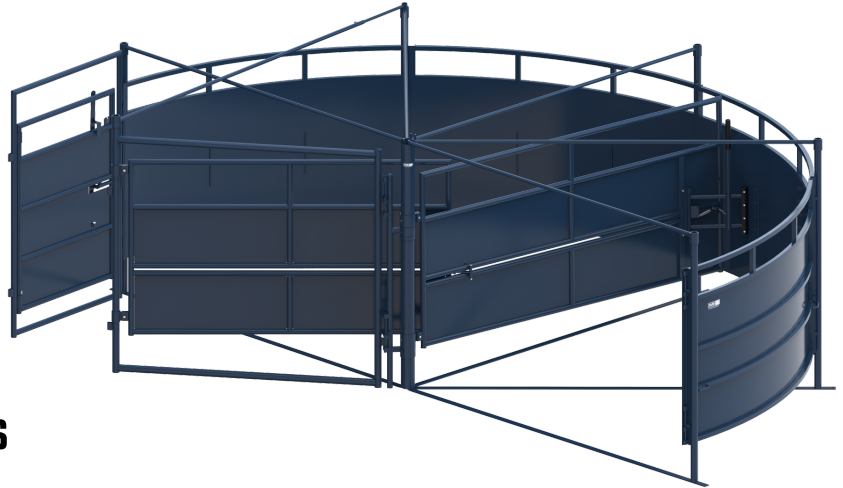
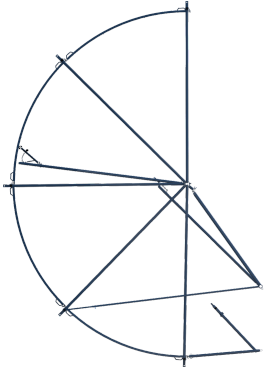

11' ELITE PROCESSING TUBS

Completely Customizable!

The heavy-duty Elite series processing tub features the two-gate eliminator system, preventing cattle from circling back to the pivot post. The gate post directs the flow of the cattle to the working alley.

- Constructed from 14 gauge square tubing and sheet metal
- 2" standard wall pipe legs
- 11' radius tub and is interchangeable for left or right-hand setup
- The panels and gates are 6' tall with bottom and top supports at 7'
- Available in 2, 3, and 4 section configurations
- Comes standard with a load out gate located at the exit of the tub

FIND THE ALLEY THAT WORKS FOR YOU

Parallel or Wedge Adjustable Alleys

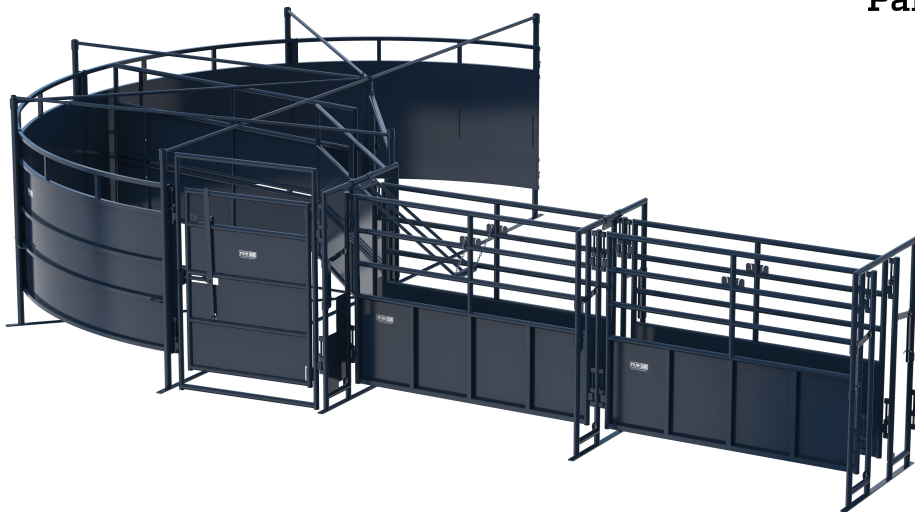

Elite Parallel sheeted alley sections are constructed from 14 gauge tubing and sheet metal.

- Each section is 8' long, & can be adjusted from 16" to 32" wide
- The panels mount 6' tall on easily adjustable frames

Elite Wedge Alley is also easily adjustable, with the bottom maintaining at 16" width.

- Sections can be infinitely added
- 2-section Alleys come standard with one no-back gate
- Adjustment latches and hinge points are specifically located to avoid manure and reduce rust and corrosion

800 W. CORTEZ ST. MONTEZUMA, KS 67867. P. (620)846-6767
WWW.MJELIVESTOCKEQUIPMENT.COM