

# THE ELITE ELIMINATOR

## Tub & Alley System

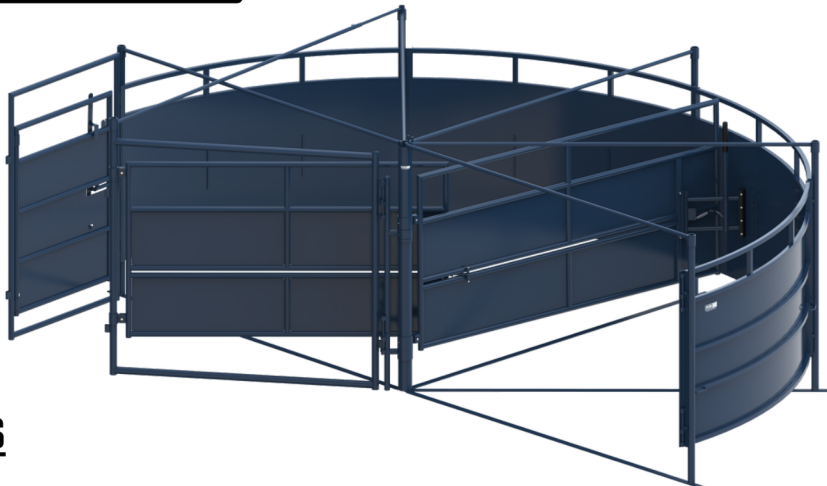

LIVESTOCK EQUIPMENT

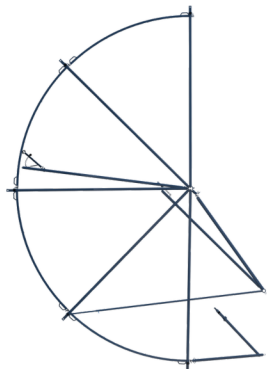

### **11' ELITE PROCESSING TUBS**

#### **Completely Customizable!**

The heavy-duty Elite series processing tub features the two-gate eliminator system, preventing cattle from circling back to the pivot post. The gate post directs the flow of the cattle to the working alley.

- Constructed from 14 gauge square tubing and sheet metal
- 2" standard wall pipe legs
- 11' radius tub and is interchangeable for left or right-hand setup
- The panels and gates are 6' tall with bottom and top supports at 7'
- Available in 2, 3, and 4 section configurations
- Comes standard with a load out gate located at the exit of the tub

### **FIND THE ALLEY THAT WORKS FOR YOU**

#### **Parallel or Wedge Adjustable Alleys**

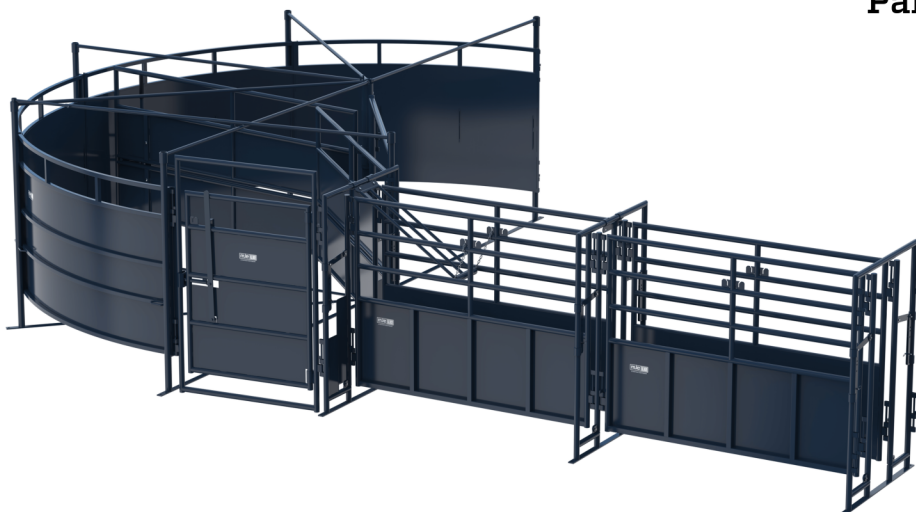

Elite Parallel sheeted alley sections are constructed from 14 gauge tubing and sheet metal.

- Each section is 8' long, & can be adjusted from 16" to 32" wide
- The panels mount 6' tall on easily adjustable frames

Elite Wedge Alley is also easily adjustable, with the bottom maintained at 16" width.

- Sections can be infinitely added
- 2-section Alleys come standard with one no-back gate
- Adjustment latches and hinge points are specifically located to avoid manure and reduce rust and corrosion

**800 W. CORTEZ ST. MONTEZUMA, KS 67867. P. [620]846-6767**  
**WWW.MJELIVESTOCKEQUIPMENT.COM**